

DOMESTIC FOWL PERMIT APPLICATION

This permit is required to keep and maintain or allow six (6) live chickens on an owner-occupied lot located in a residential zoning district within the Village of Hartville as specified in Ordinance 1-13.10.

Applicant/Property Owner Information:

Applicant: _____ Date: _____

Property Owner: _____

Address (where chickens are to be kept): _____

Contact #: _____

Application/Permit Fee:

The fee is \$50.00 for up to six (6) chickens. (Make checks payable to the Village of Hartville). This application/permit is good for one (1) year, with a renewal fee of \$25.00 due thereafter.

Regulations for Keeping Chickens

Total number of chickens to be kept: _____ (a maximum of six chickens are allowed per residential lot)

You must provide the following with your application:

- ___ Scaled Site Plan (including size of coup, setback from property lines) along with the Zoning Permit.
- ___ Drawing or photograph of the chicken coup, including materials and colors.
- ___ Proof of Property Ownership.

The applicant must read the following statement carefully and sign below:

I hereby certify that I am the owner of record of the subject property. I hereby declare, under penalty of perjury, that this application and all attachments thereto are true, correct, and complete to the best of my knowledge. In submitting the signed application, I acknowledge that it is my responsibility to comply with the terms and conditions of a Domestic Fowl Permit issued.

The Domestic Fowl Permit is valid for one (1) year. After the one (1) year, applicant may reapply for a renewal permit. The permit may be revoked if the permittee is convicted of one or more violations. Denials and/or revocations of permits may be appealed in writing to the Office Manager within 20 days of receipt of the denial or revocation.

Applicant Signature Date _____

CERTIFICATION OF ZONING INSPECTOR'S EXAMINATION

I have examined the foregoing application, plans and information, found them not / to conform with the zoning requirements and grant / refuse them a Zoning Permit.

By _____ Date _____

STORM WATER RUN-OFF APPROVAL
By Village Engineer
Sanitary Hookup Approval
By Board of Public Affairs
Lateral Installation Inspection
By Sewer Inspector

VILLAGE OF HARTVILLE, OHIO
ZONING DEPARTMENT
APPLICATION FOR
ZONING PERMIT

Zoning permit No. _____

Date Issued _____

SANITARY DISCHARGE APPROVAL
BY BOARD OF PUBLIC AFFAIRS

Date: _____

A scale plan must be submitted with this application showing the size and location of the Lot, the dimensions and location of the proposed building or structure on the lot and the dimensions and location of existing buildings or structures on the lot.

Name of Applicant _____ Phone _____

Address _____

Owner of Premises _____ Address _____

Application is hereby made to: (Description of Work) _____

To be used for (Indicate purpose, number of units or offices, etc.) _____

On premises located at _____

DESCRIPTION

(1) Size of lot: _____ feet wide _____ feet deep

(2) Size of building or structure: Floor area _____
Maximum: Width _____ ft. Depth _____ ft.
Height: Stories: _____; feet _____

(3) Location on Property:

Proposed Yards

FRONT _____ ft. from Property Line to Building or Structure.
SIDE _____ ft. from Property Line to Building or Structure.
SIDE _____ ft. from Property Line to Building or Structure.
REAR _____ ft. from Property Line to Building or Structure.

(4) Character of Construction _____
(Brick, Frame)

(5) Estimated Cost of Work \$ _____

(6) Present use of Land, Existing Buildings or Structures on Lot: _____

Signature of Applicant

Please note any additional information on separate sheet and attach to this form.

CERTIFICATION OF ZONING INSPECTOR'S EXAMINATION

I have examined the foregoing application, plans and information, found them not / to conform with the zoning requirements and grant / refuse them a Zoning Permit.

By _____ Date _____

REGULATIONS FOR KEEPING DOMESTIC FOWL

1. A permit shall be issued only to the primary owner(s) of record of a single family residence located in a residential district. The permittee must reside on the premises regulated by the permit.
2. The propagation of chickens for commercial purposes or for any purpose not related to the personal use of the permit holder is prohibited; this includes fertilizer production and/or the sale of eggs.
3. Roosters shall be prohibited.
4. No person shall slaughter any chickens on the premises regulated by the permit.
5. Chickens shall be housed within a detached stationary structure used only for hens.
6. One henhouse shall be permitted per lot, provided that the property does not include a storage shed, gazebo or other similar building.
7. Temporary and/or movable devices and structures – including chicken tractors – shall be prohibited.
8. Chickens shall be secured within a henhouse during non-daylight hours.
9. Chickens may not roam free outside of a henhouse or enclosed run.
10. The maximum size of a henhouse shall not exceed 18 square feet.
11. No henhouse or henhouse shall be located no closer than 20 feet from any property line and 50 feet away from any residence.

Domestic Fowl Permit Site Plan

Name _____ Phone _____

Address _____ No. of Hens _____

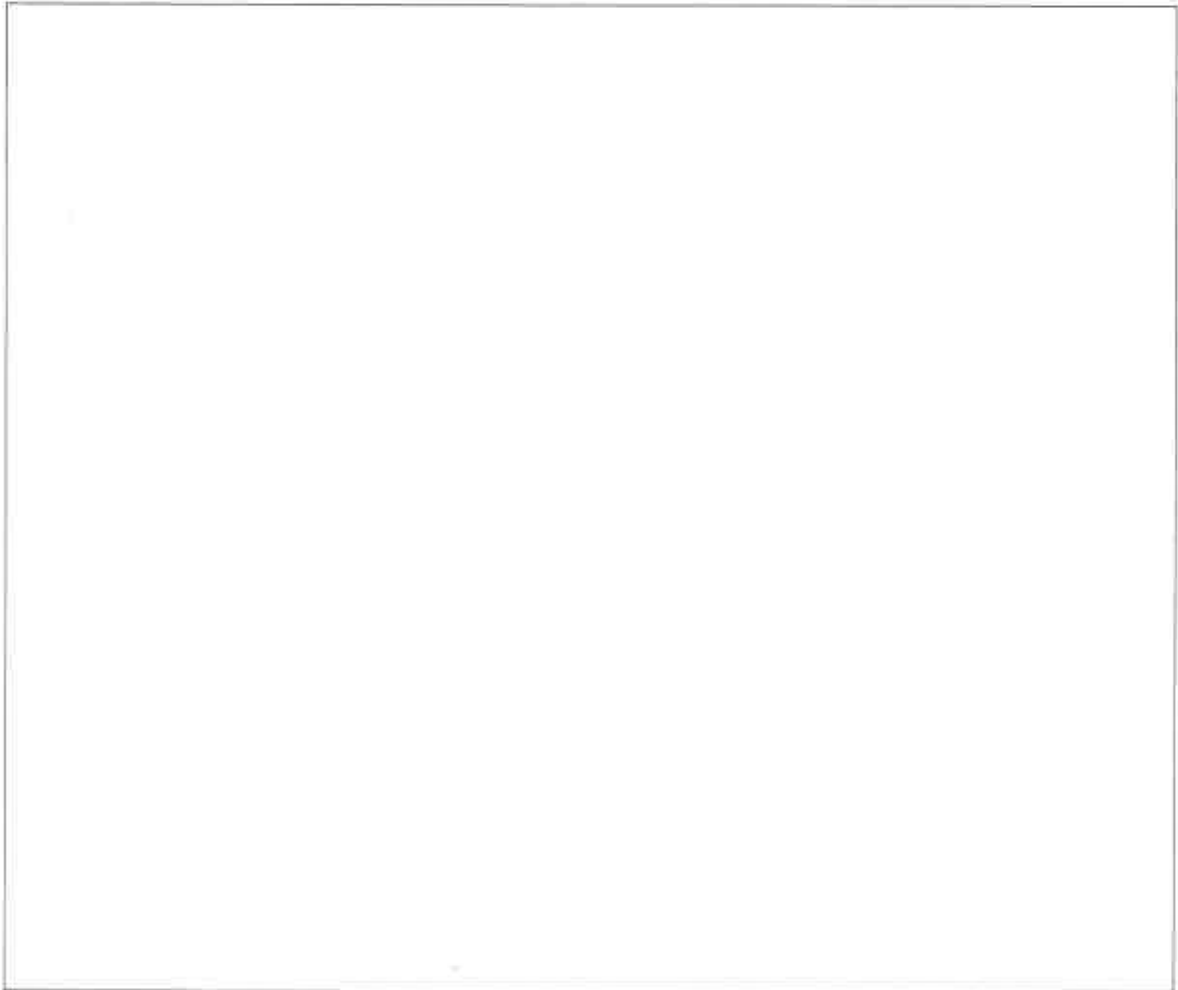
A large, empty rectangular box with a thin black border, intended for the applicant to draw their Domestic Fowl Permit Site Plan. The box is currently blank.

Domestic Fowl Permit Site Plan

Name _____ Phone _____

Address _____ No. of Hens _____

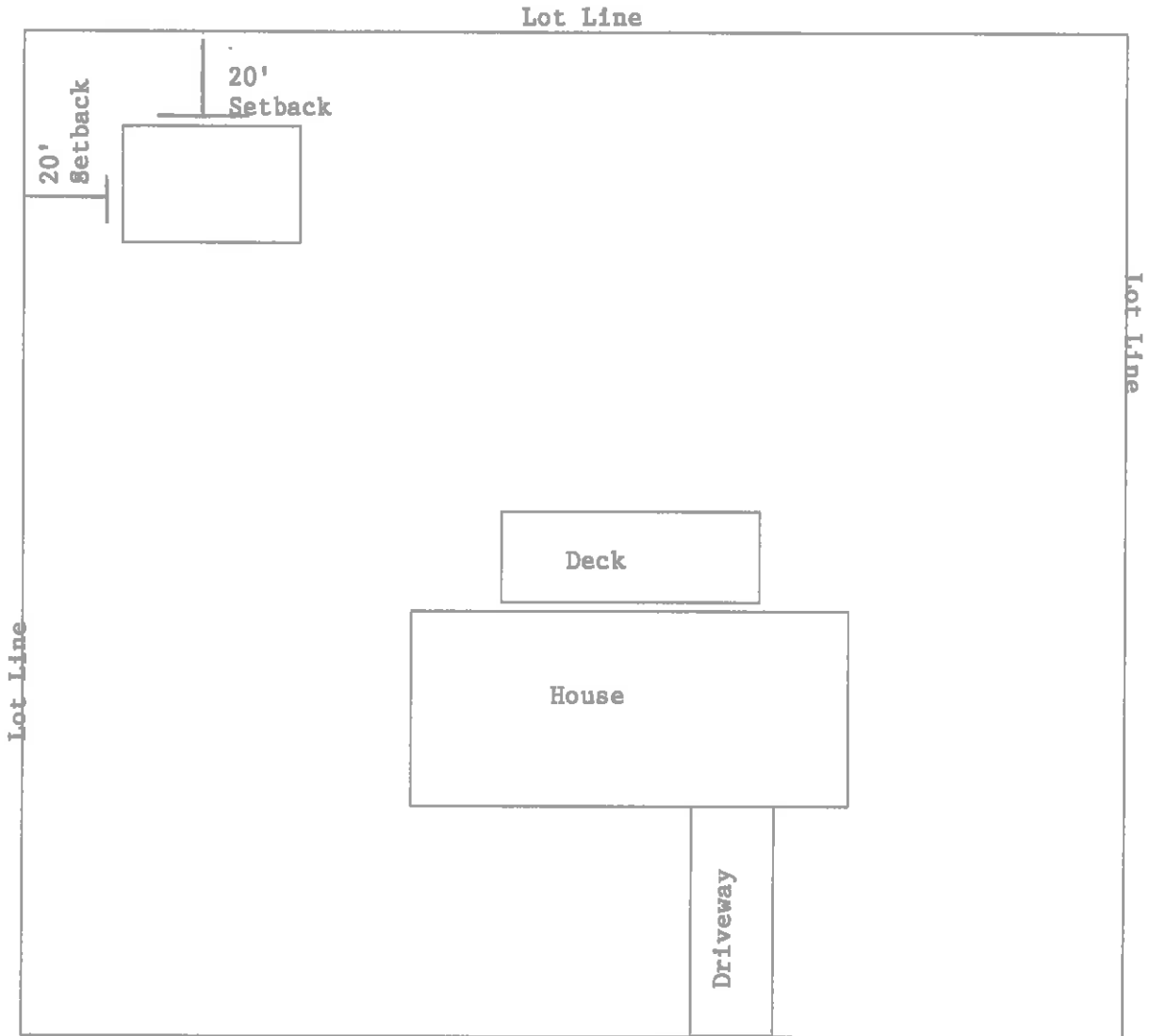

SAMPLE